

ORDINANCE NO. 2126

AN ORDINANCE OF THE COUNCIL OF THE CITY OF SALISBURY, MARYLAND AMENDING ORDINANCE NO. 2058 SECTION A – LOT RATES TO ADD A PARKING PERMIT RATE FOR PARKING LOT #35, EFFECTIVE DECEMBER 1, 2010.

WHEREAS, Ordinance No. 2058, section A – Lot Rates has previously established parking permit rates for City parking lots, adopted on July 14, 2008 and signed July 15, 2008; and

WHEREAS, the parking lot closest to the City Marina, known as parking lot #35, has not previously had a rate for a monthly permit; and

WHEREAS, the City has received a request from a local business to purchase permits in lot #35 for its employees; and

WHEREAS, the City would like to accommodate this request, but in order to do so it is necessary to establish a rate for a monthly permit; and

WHEREAS, lot #35 is not located in the central part of the downtown area; and

WHEREAS, it is reasonable to establish a rate for this lot consistent with other lots that are also located on the peripheral to downtown; and

WHEREAS, other such peripheral lots of the City all have a monthly permit rate of nine dollars (\$9.00).

NOW, THEREFORE, BE IT ORDAINED, by the Council of the City of Salisbury that the monthly parking permit rate for parking lot #35 shall be nine dollars (\$9.00) from December 1, 2010 and thereafter unless and until subsequently revised or changed and the chart in Ordinance No. 2058, section A - Lot Rates, will be amended to include Lot 35 as follows:

Lot Number/Location	Monthly Parking Rate
Lot 1	\$30
Lot 4	\$30
Lot 5	\$27
Lot 10	\$23
Lot 11	\$25
Lot 12	\$25
Lot 15	\$30
Lot 15	\$30
Lot SPS	\$30

Church Street East & West	\$30
Parking Garage	\$30
Lots 30/31	\$9
Lots 7/13	\$9
<b>Lot 35</b>	<b>\$9</b>

THIS ORDINANCE, was introduced and read at a meeting of the Council of the City of Salisbury, Maryland held on the 25<sup>th</sup> day of October, and thereafter, a statement of the substance of the Ordinance having been published as required by law, was finally passed by the Council on the 22<sup>nd</sup> day of November, 2010.

ATTEST:

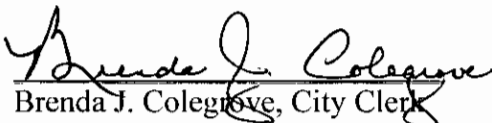
  
Brenda J. Colegrove, City Clerk

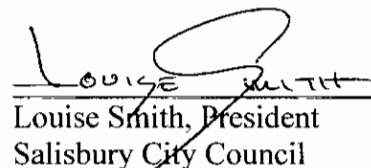
  
Louise Smith, President  
Salisbury City Council

APPROVED BY ME THIS

23 day of November, 2010

  
James Preton, Jr., Mayor

# Memo

**To:** John R. Pick, City Administrator  
**From:** Pamela B. Oland, Director of Internal Services *PBO*  
**Date:** October 14, 2010  
**Re:** Permit Rate for Lot #35

---

The Parking Authority has received a request from a local business to sell 8 monthly parking permits for lot #35, the lot nearest the City Marina. Due to the fact that this lot is very lightly used during day time hours, we feel comfortable with selling a limited number of permits. This parking lot was previously a free lot; however, starting in fiscal 2010, we started charging meter rates at the lot. We have never sold permits in this lot, and therefore, we have never set a monthly permit rate. Based on our parking lot study, and the fact that this lot is the furthest from the downtown, we are requesting that the rate be set the same as our other peripheral lots (lots 7, 13, 30 and 33) at \$9.00 a month. The CCDC considered this request at their most recent meeting and unanimously supported this permit rate. Attached please find an ordinance setting the parking permit rate for this parking lot. If you have any questions, please let me know.

Municipal Lot Info

Lot #	Acres
Lot 1	2.70
Lot 4	0.52
Lot 5	0.15
Lot 10	2.70
Lot 11	0.94
Lot 12	0.44
Lot 14	0.14
Lot 15	0.47
Lot 16	0.45
Lot 30	1.08
Lot 33	0.40
Lot 35	3.85

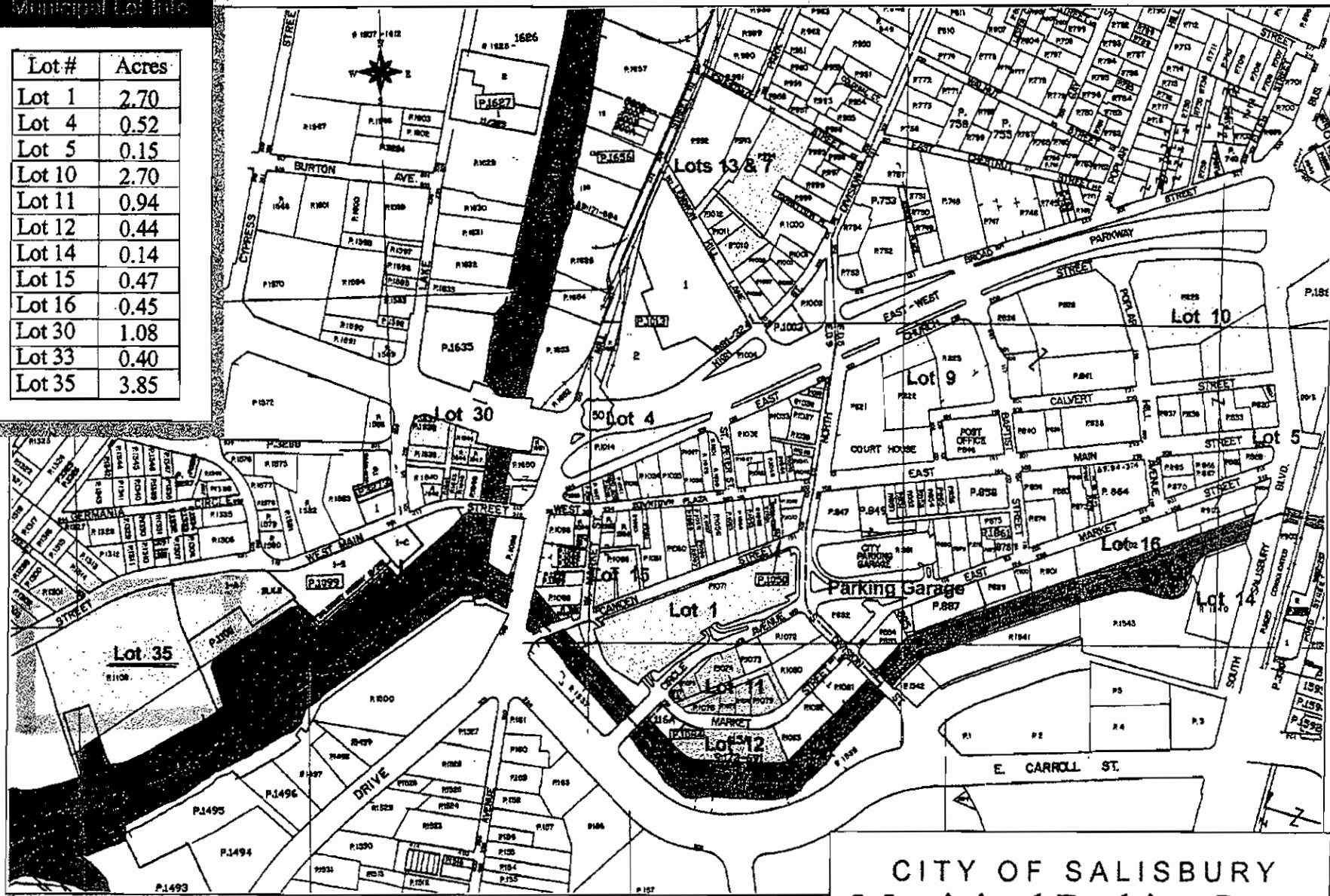

CITY OF SALISBURY  
Municipal Parking Lots

